

# Park View Commons Park View Commons A Condominium



## House Price Sheet (effective as of June 2008)

### Standard Lot Prices:

#### The Crest Cove (1,660 sq. ft.)

20' Wide with Slab \$ 204,900.00

20' Wide with Basement \$ 214,900.00

#### The Peak's Nest (1,750 sq. ft.)

21' Wide with Slab \$ 217,900.00

21' Wide with Basement \$ 227,900.00

Premium Lots (Buildings 6—12):

Add \$8,500.00

Walk Out Basement, add \$5,000.00

**The above prices are subject to change at any time or from time to time in the sole discretion of the builder.**

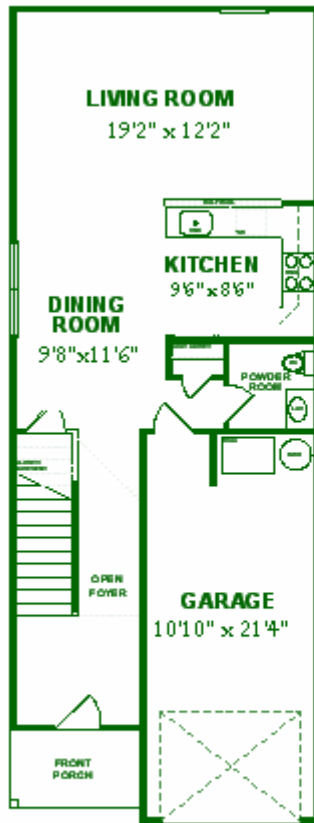

**FIRST FLOOR**

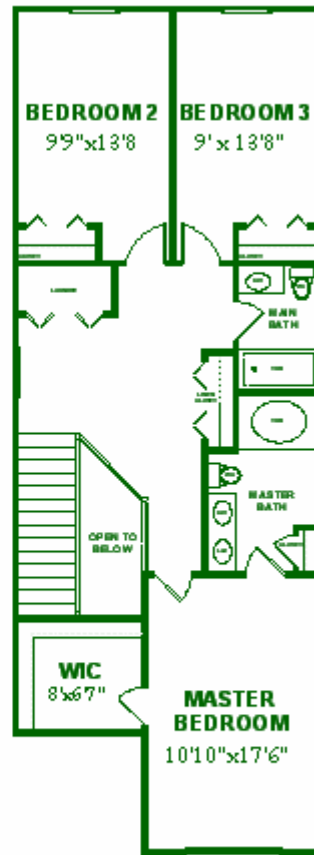

**SECOND FLOOR**

The Crest Cove

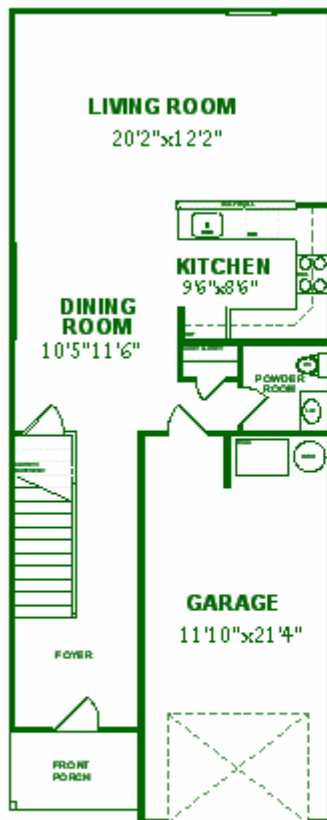

**FIRST FLOOR**

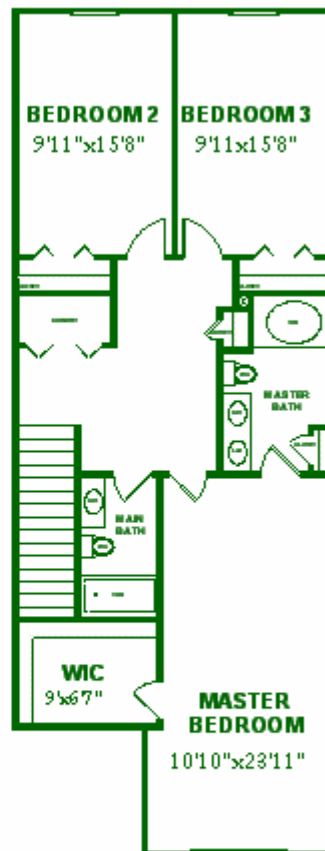

**SECOND FLOOR**

The Peak's Nest

**Standard Features:**

Living Room, Dining Room, Kitchen, 3 Bedrooms,  
2 ½ Bathrooms, Laundry Closet,  
Garage and Appliance Package (Electric Range,  
Oven, Dishwasher, and Microwave)  
Central Air Conditioning & Electric Heat Pump  
(See Specification Sheet for more details).

**Condominium Association:**

Public Offering Statement  
Declaration of Condominium  
Condominium Association Bylaws  
Condominium Association fees: \$115/unit/month

**Amenities Include:**

Acres of Wooded Open Space  
Pedestrian Pathway along William Street, leading to the Public  
Park, Ball Fields and Saucon Creek.

# Located in the City of Bethlehem, Pennsylvania

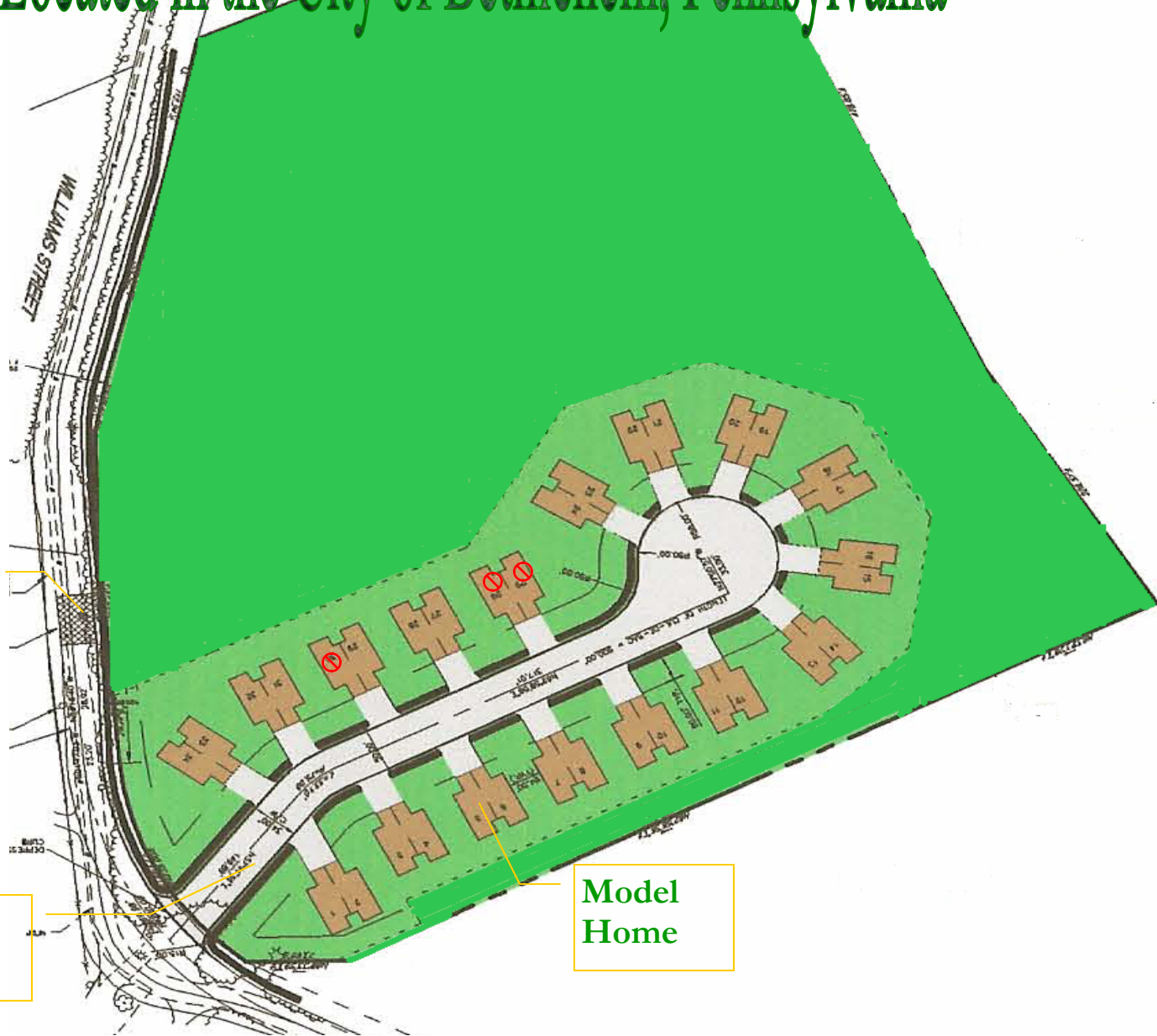

These condominium units are situated mere minutes away from I-78, yet they sit in the wonderfully scenic Lehigh Valley mountainside.

The stately exterior of each building perfectly compliments the wooded landscape of Park View Commons.

From I-78, take Exit 67 (Hellertown/Bethlehem).

Turn onto Silvex Road (next to Wendy's). Drive 0.3 miles on Silvex Road to College Drive. Turn left onto College Drive and drive 0.2 miles to William Street.

Turn right onto William Street and go 0.6 miles to the top of the hill.

Crest Park Court is on your left.

Our Model Home is under construction on the right-hand side.

We hope that you enjoy your visit!